

MODEL 115 FIRE DOOR LIGHT FRAME

OUR PREVIOUS STANDARD UNIT

ORDER INFORMATION:

ORDER SIZE = Inside dimension of frame, (W+H)

CUTOUT SIZE = Order size + 1 1/2"

GLASS SIZE = Order size + 3/4"

UL & WHI LISTED

Meets UL10B requirements for NEGATIVE PRESSURE and UL10C & UBC 7-2(1997) for POSITIVE PRESSURE. Refer to AMS Listing Specifications. Fire tested WITHOUT glazing compound, tape or intumescent.

MATERIAL:

- 18 GA. CRS frame is standard.
- 33% thicker than 20 GA. Frames

FINISH:

- Beige polyester powder coating.
- Extremely durable
- Visually appealing

OPTIONS:

- 18 GA. Galvanized for exterior use.
- 18 GA. Stainless Steel for hospital and food service.
- Custom colors.
- Wood veneer wrap in various species to match door.

MOUNTING HOLES:

- 11" length or less, one hole centered.
- Over 11", three inches maximum from corners. 11 5/16" maximum centers.

#8-32 Flat head machine screw. (included)

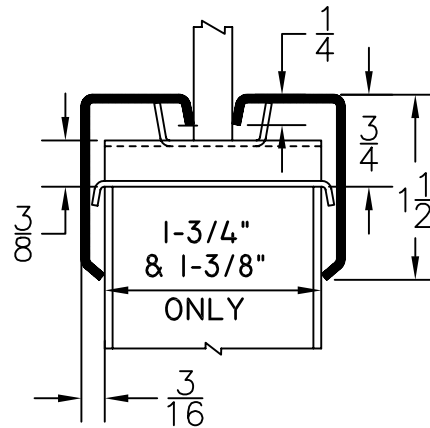

NO GLAZING COMPOUND, TAPE or INTUMESCENT

is required for most label applications.

- Reduces cost
- Simplifies installation
- Improves appearance

WELDED STIFFENER

- Reduces corner flex.

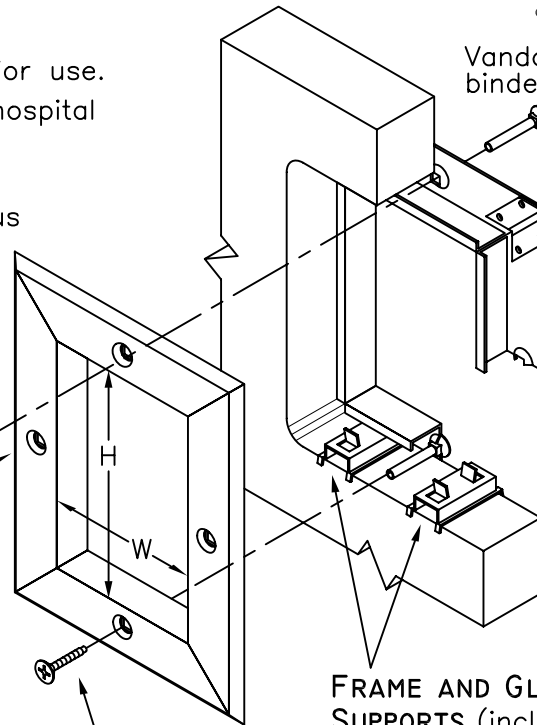

FRAME AND GLASS SUPPORTS (included)

Must be used for proper installation. Two required.

GLASS NOTE: For non-fire rated applications we recommend 1/4" Tempered glass. If laminated glass is used, glazing tape and light torque on the screws is required to prevent glass breakage.

LAMINATED GLASS
NOT RECOMMENDED
SEE GLASS NOTE.

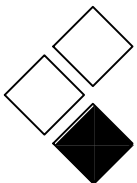

ALL METAL STAMPING, INC.

411 W. Spruce St., P.O. Box 485, Abbotsford, Wisconsin 54405-0485
Phone (715) 223-6324 Fax (715) 223-3352 Patent NO. 4,550,542